

Netztransformator | Powertransformer - TT-pwTW100

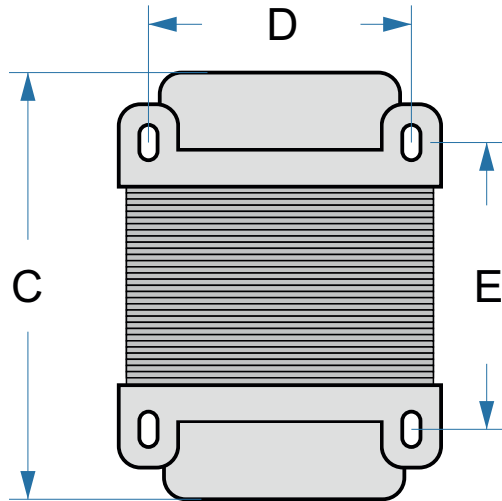
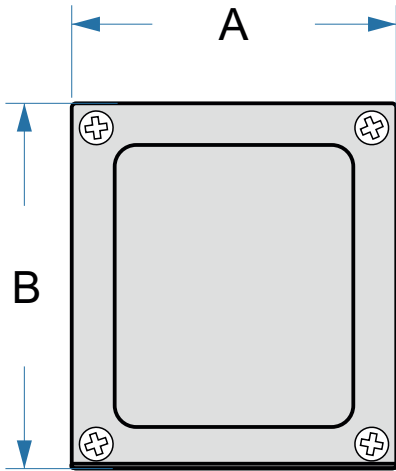

Größe | Dimension [mm]

A: 132
B: 90
C: 134
D: 90
E: 92

+/- 1 mm

Primär | Primary

Schwarz / Black - 0V

Braun / Brown 120 V

Grau / Grey - 0 V

Blau / Blue - 110 V

Weiß / White - 120 V

Sekundär | Secondary

Rot / Red - 300 V

Grau / Grey 300 V

Lila / Purple 300 V

Schwarz / Black 300 V

Grün / Green - 3,2 V

C.T. Schwarz / Black

Grün / Green - 3,2 V

Pink - 55 V

Pink - 55 V

Orange - 5 V

Orange - 0 V

Zeichnung nicht maßstabgetreu
Drawing not to scale

Spezifikation | Specification

Pri: 0-120V / 0-110-120V @ 50/60Hz

Bias: 0-55V @ 500 mA

H1: 0-5V @ 6 A

H2: 3,15 - 0 - 3,15 V @ 8 A

Sec1: 330V @ 300 mA

Sec2: 330V @ 300 mA

(Half-Wave: 330 V - 0 - 330 V)

(Full-Wave: 330 V - 0 V)

EN61558

